

SMOKE

Soot and Grease Abatement Systems



For the Future of Heat FOCUS DOGU

With our R&D investments and competent team leading the HVAC sector, we are at the forefront of designing HVAC products that are **both human-and environmentally-friendly.**

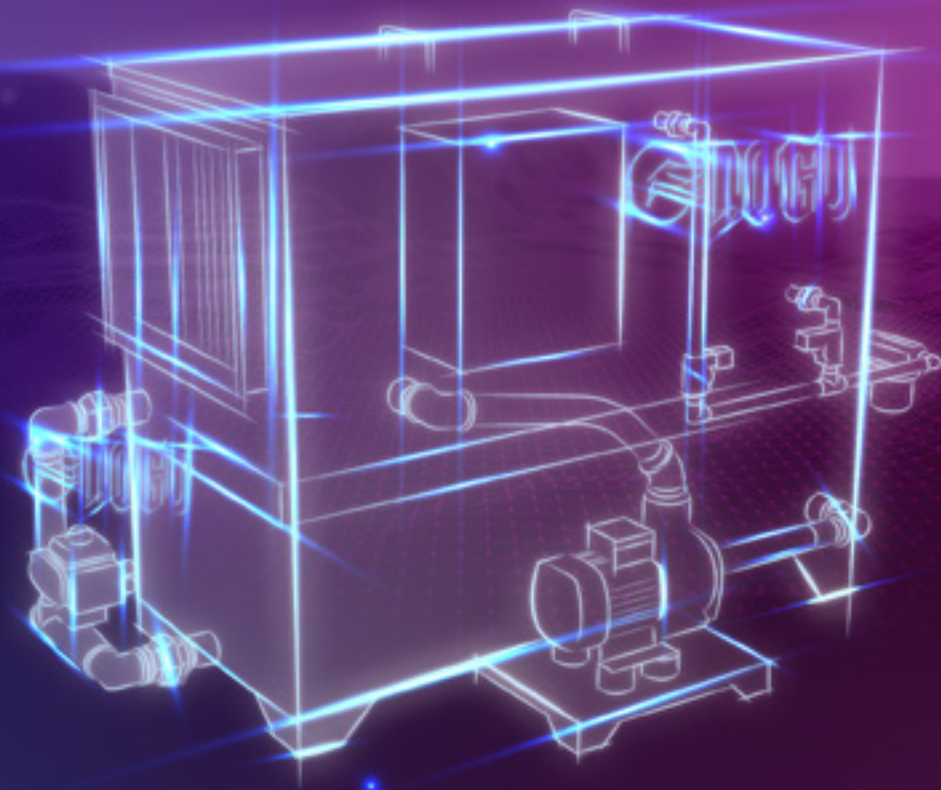

SMOKE

Soot and Grease Abatement Systems

SMOKE

Soot and Grease Abatement Systems

FEATURES



- ⌚ Economical solution for charcoal and wood-fired cooking
- ⌚ High efficiency filtration
- ⌚ Fully automatic control system
- ⌚ Low energy consumption
- ⌚ Low water consumption
- ⌚ Complete stainless design
- ⌚ Control accessibility through automation
- ⌚ Long life expectancy
- ⌚ Compatible with BMS

The FOUR SMOKE device has been developed for kitchens with charcoal grills and wood-fired cooking, where there is intense smoke and various contaminant output. The device is used to keep contaminants such as soot and oil in the smoke coming from the hood and to eliminate the flame and spark carried along with the air. The dirty air that enters the device in black color is discharged in a smoothened form after washing.

The device, which is based on the principle of washing the exhaust air with pressurized water and filtering it through filters, is produced in between 3000 m³/h and 7500 m³/h airflows. In systems where the Four SMOKE device is used, it minimizes the risk of fire and malfunction of other kitchen ventilation systems. The unit circulates the water in it with the help of a circulation pump. Thus, it does not constantly use water from the mains water and automatically detects a decrease in water level and supplies water with a solenoid valve. When the circulating water in the unit pool gets dirty, it can be manually drained at times determined by the user, and automatic cleaning inside the unit can be performed.

- AISI 304 stainless steel body,
- Centrifugal pump with stainless body and stainless steel impeller,
- Stainless nozzles and connection elements,
- 3 stages filtration,
- Integrated automation system,
- Compatible operation with other kitchen exhaust units and BMS,
- Ease of maintenance and servicing

Models	Airflow [m³/h]	Pump Power [kW]	Water Consumotion [lt]	Unit Weight [kg]	Full Weight [kg]
Smoke - 3000	3000	1,1	225	370	465
Smoke - 5000	5000	1,5	280	470	565
Smoke - 7500	7500	2,2	385	670	725
Smoke - 10000	10000	2,2	470	445	915

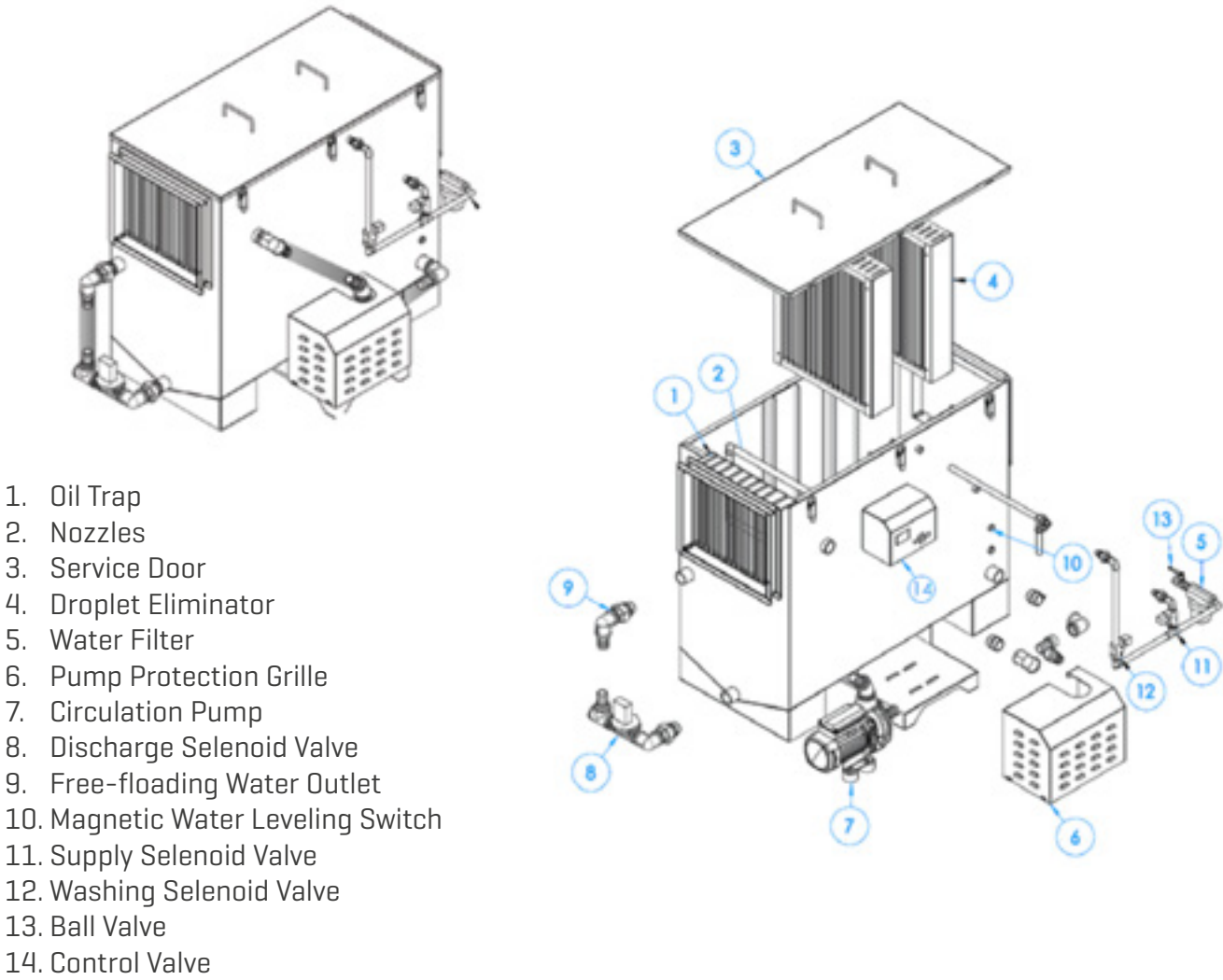

DIMENSIONS

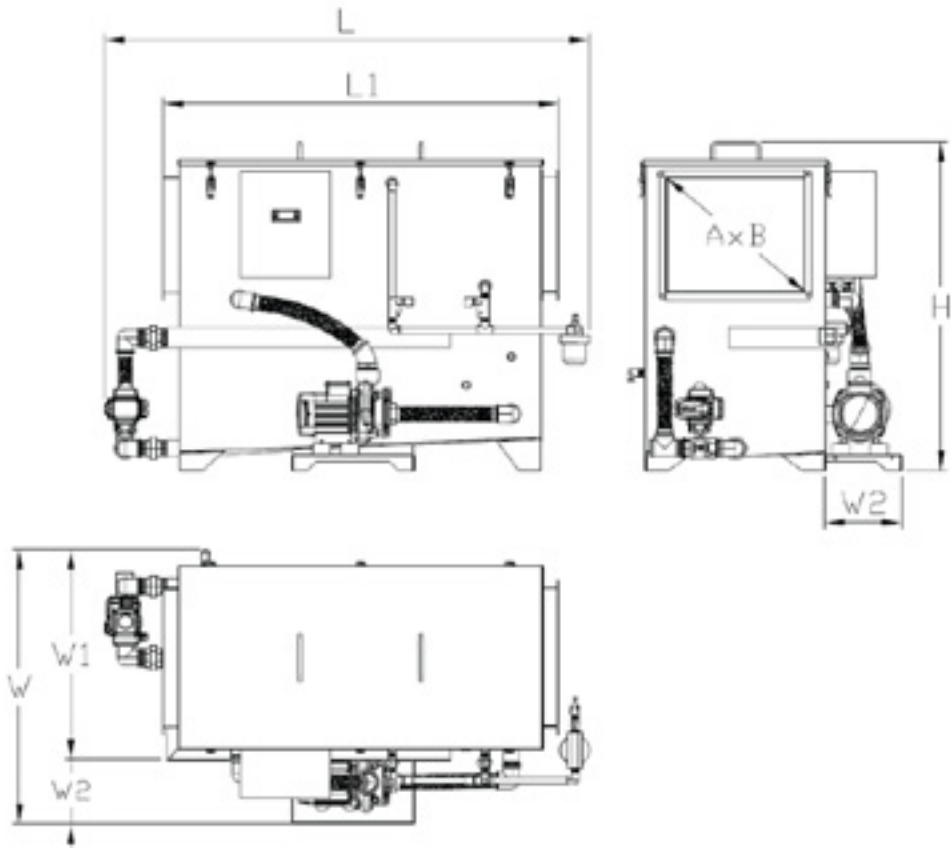

Models	L	L1	W	W1	W2	H	AxB
Smoke - 030	1610	1310	910	700	250	1050	375x455
Smoke - 050	1610	1310	1060	850	250	1210	600x550
Smoke - 075	1610	1310	1330	1100	250	1330	900x550
Smoke - 100	1610	1310	1600	1350	250	1440	970x705

Note: Dimesions are in mm.

SUSTAINABILITY SOLUTIONS AT DOGU HVAC



We offer supplementary health insurance to our employees to promote healthy living. We also plan health-focused initiatives such as smoking cessation programs.



Through the DOGU HVAC CLUB project, we organize technical tours of our factory, participate in career events, and provide sponsorships to support the skill development of university and technical high school students.



In 2024, we increased female employment in our administrative and production departments. This step aims to contribute to gender equality by offering a workplace with equal rights for all employees.



Our R&D center's 2,500 m² solar panels and 0.6 MW annual capacity solar energy systems reduce our carbon footprint. We generate our electricity, ensuring a reliable, sustainable, and accessible clean energy source.

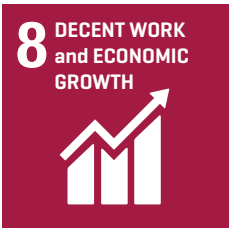

Decent Work and Economic Growth: As an employer brand, our primary goal is to protect our employees' rights and create a workplace founded on equality and justice for all employees.



We enhance indoor air quality with environmentally friendly and energy-efficient products, ensuring adherence to European standards.



We minimize waste through lean production policies and emphasize recycling, simultaneously increasing efficiency in our production processes.



We support environmental protection through our eco-friendly, sustainable, energy-efficient product lines and R&D efforts focused on reducing waste that could contribute to climate change.



We value transparency and accountability, working with associations like ISKAV to prevent corruption and unfair competition, aligning with sectoral ethical values.



Venues Breathe With Us



Read to watch our
promotional video

